

" Chúng tôi cam kết nỗ lực hết mình vì sự tin tưởng, hợp tác của Quý khách hàng. Hy vọng rằng, trong thời gian tới chúng tôi rất mong tiếp tục được đón nhận sự ủng hộ nhiệt thành của Quý khách hàng, đó là niềm động viên to lớn để chúng tôi tiếp tục nâng cao chất lượng, dịch vụ nhằm đáp ứng nhu cầu ngày càng cao của Quý khách. "



CÔNG TY TNHH XUẤT NHẬP KHẨU CÔNG NGHỆ VITECH

Contact Us



Thiết bị và linh kiện thang máy Vitech

📍 A54 Khu tái định cư LK19A, LK19B, X7, Hà Đông, Hà Nội

☎ 0948 699 579

VISION
AND
SMART
TECHNOLOGY

<http://www.vi-tech.com.vn/home/>



CÔNG TY TNHH XUẤT NHẬP KHẨU CÔNG NGHỆ VITECH

CONTACT US



0865 253 588

0865 140 588

0988 247 809

0867 182 588



Một số hình ảnh công ty

MỤC LỤC

1. Tủ điều khiển AS380 ThaiLand	Trang 01
2. Máy kéo Torin ThaiLand	
2.1 Máy kéo Torin không hộp số.....	Trang 02 - 03
2.2 Máy kéo Torin có hộp số.....	Trang 04 - 06
3. Tủ điều khiển FJE Korea	Trang 07
4. Máy kéo Fuji Korea FJE	
4.1 Máy kéo FJE325	Trang 08
4.2 Máy kéo FJE400	Trang 09 - 10
4.3 Máy kéo FJE200	Trang 11 - 12
5. Tủ điều khiển Fuji ThaiLand FJT - C	Trang 13
6. Máy kéo Fuji ThaiLand FJT	
6.1. Máy kéo FJT325	Trang 14
6.2. Máy kéo FJT400	Trang 15 - 16
7. Đầu cửa cabin & đầu cửa tầng Ningbo NBSL.....	Trang 17
8. Đầu cửa cabin Ningbo Outling	Trang 18
9. Bộ không chế tốc độ trên & dưới.....	Trang 19 - 20
10. Thắt cơ	Trang 21
11. Ty cáp & Shoe dẫn hướng cabin/ đối trọng.....	Trang 22
12.Cáp tải Korea	Trang 23
13. Thanh an toàn cảm ứng WECO	Trang 24
14. Rail Marazzi.....	Trang 25 - 26
15. Button.....	Trang 27 - 30
16. Encoder.....	Trang 31
17. Thiết bị khác	Trang 32 - 33

GIỚI THIỆU

Công ty TNHH Xuất nhập khẩu Công nghệ Vitech là công ty chuyên cung cấp thiết bị, linh kiện thang máy.

Chúng tôi nhận thức rằng "**Đạo đức kinh doanh**" là yếu tố cốt lõi ảnh hưởng đến tính nhân văn, sự sống còn và phát triển của công ty. Bởi vậy, Vitech luôn lựa chọn, phân phối những sản phẩm có tính thẩm mỹ và chất lượng cao, giá thành hợp lý nhằm đáp ứng yêu cầu và nhu cầu khác nhau của khách hàng.

Vitech tồn tại, phát triển, khẳng định vị thế của riêng mình nhờ sự lựa chọn khắt khe và kết hợp hai yếu tố "**Con người - Sản phẩm**". Vitech hiểu rất rõ rằng "**Chỉ có nỗ lực phụng sự mới có thể dẫn đầu**" trân trọng sản phẩm như máu thịt của mình, trân trọng khách hàng như người thân của mình, phục vụ khách hàng như phục vụ chính mình.

Vitech luôn luôn nỗ lực xây dựng đội ngũ nhân viên chuyên nghiệp, sản phẩm uy tín, chất lượng mang lại niềm tin cho khách hàng.

► **MODEL : AS380**



Rate power	2.2KW - 15KW	18.5KW - 22KW	30KW - 37KW	5.5KW - 22KW
Rate speed	≤ 2.5m/s	≤ 4m/s		≤ 2.5m/s
Inverter				
Power supply				
Motor brake voltage	DC110V			
Machineroom	Machine room type			
Motor type	Synchronous or asynchronous			
Cabinet material	Galvanized box			
Package	Wooden box			
Installation	Ground mounted			



SM.02G

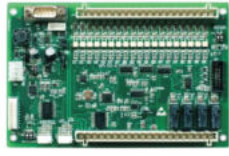

SM.02E

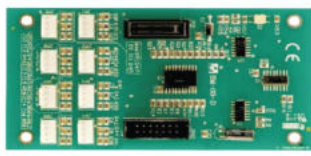

SM.03 - D



SM.02 - H

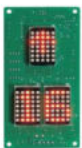

SM.04VR/K



SM.04VL16/L



SM.04VL16/L



SM.04TL/T

► **MODEL: GTW7A**

Voltage: 380V
 Suseension: 2 : 1
 FZD10 Brake: DC110V 2 x 0.84A (2 x 1.46A)
 Weight: 190kg
 Max.Static Load: 2000kg

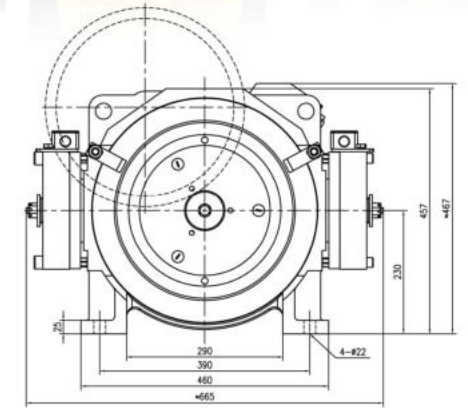
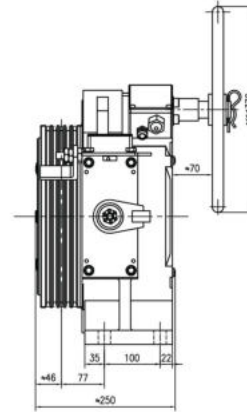
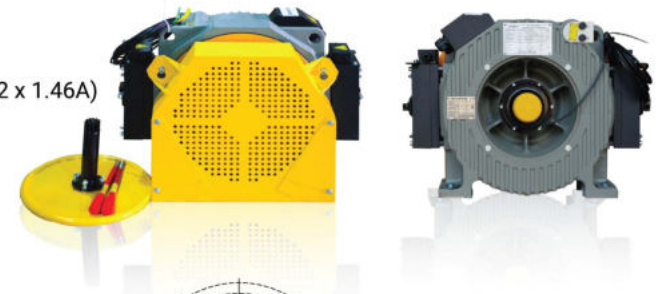

Spec	Load (kg)	Lift Speed (m/s)	Sheave Diam(mm)	Rope Sheave (mm)	Current (A)	Torque (Nm)	ated Speed (rpm)	Frequency (Hz)	Power (kW)	Pole	Rating	INS.Class	IP Code
GTW7A-31P0A	320	1	Φ325	3xΦ8x12	6.3	200	118	31.5	2.5	32	S5(40%)	F	IP41
GTW7A-31P5A	320	1.5	Φ325	3xΦ8x12	8.9	200	177	47.2	3.7	32	S5(40%)	F	IP41
GTW7A-31P6A	320	1.6	Φ325	3xΦ8x12	9.4	200	189	50.4	4	32	S5(40%)	F	IP41
GTW7A-31P7A	320	1.75	Φ325	3xΦ8x12	9.4	200	206	54.9	4.3	32	S5(40%)	F	IP41
GTW7A-41P0A	450	1	Φ325	4xΦ8x12	8.3	265	118	31.5	3.3	32	S5(40%)	F	IP41
GTW7A-41P5A	450	1.5	Φ325	4xΦ8x12	11.9	265	177	47.2	4.9	32	S5(40%)	F	IP41
GTW7A-41P6A	450	1.6	Φ325	4xΦ8x12	13.7	265	189	50.4	5.2	32	S5(40%)	F	IP41
GTW7A-41P7A	450	1.75	Φ325	4xΦ8x12	13.7	265	206	54.9	5.7	32	S5(40%)	F	IP41
GTW7A-51P0A	550	1	Φ325	5xΦ8x12	8.6	290	118	31.5	3.6	32	S5(40%)	F	IP41
GTW7A-51P5A	550	1.5	Φ325	5xΦ8x12	12.4	290	177	47.2	5.4	32	S5(40%)	F	IP41
GTW7A-51P6A	550	1.6	Φ325	5xΦ8x12	14.3	290	189	50.4	5.7	32	S5(40%)	F	IP41
GTW7A-51P7A	550	1.75	Φ325	5xΦ8x12	14.3	290	206	54.9	6.3	32	S5(40%)	F	IP41
GTW7A-61P0A	630	1	Φ325	5xΦ8x12	9.6	325	118	31.5	4	32	S5(40%)	F	IP41
GTW7A-61P5A	630	1.5	Φ325	5xΦ8x12	13.9	325	177	47.2	6	32	S5(40%)	F	IP41
GTW7A-61P6A	630	1.6	Φ325	5xΦ8x12	16	325	189	50.4	6.4	32	S5(40%)	F	IP41
GTW7A-61P7A	630	1.75	Φ325	5xΦ8x12	16	325	206	54.9	7	32	S5(40%)	F	IP41

► MODEL: GTW9S

Voltage : 380V
 Suspension: 2:1
 Brake : DC110V 2×1.0A
 Max.Static Load : 3000kg

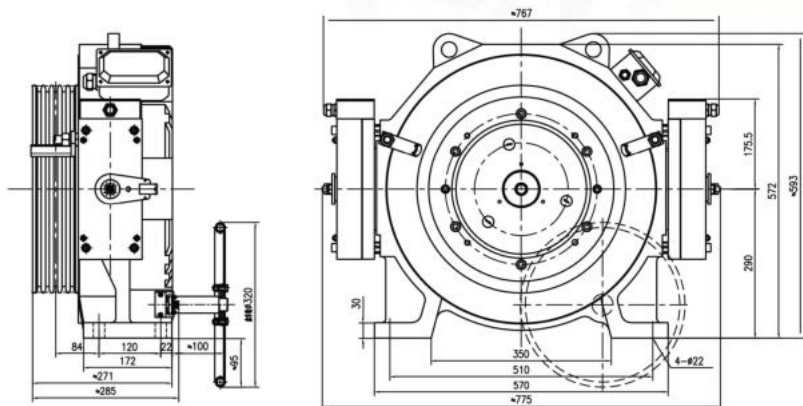
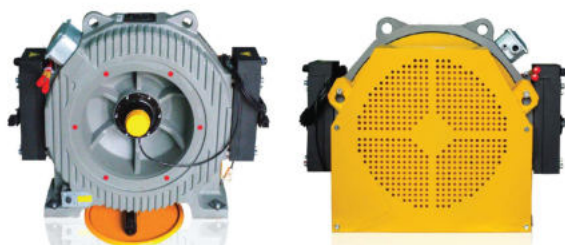

Spec	Load (kg)	Lift Speed (m/s)	Height (m)	Sheave Diam(mm)	Rope Sheave (mm)	Current (A)	Torque (Nm)	Rated Speed (rpm)	Frequency (Hz)	Power (kW)	Pole	Rating	INS.Class	IP Code
GTW9S-61P0A	630	1	≤80	Φ400	4×Φ10×16	9.7	389	96	25.6	3.9	32	S5(40%)	F	IP41
GTW9S-61P5A	630	1.5	≤80	Φ400	4×Φ10×16	14.9	420	144	38.4	6.3	32	S5(40%)	F	IP41
GTW9S-61P6A	630	1.6	≤80	Φ400	4×Φ10×16	14.9	420	153	40.8	6.7	32	S5(40%)	F	IP41
GTW9S-61P7A	630	1.75	≤80	Φ400	4×Φ10×16	15.9	420	167	44.5	7.3	32	S5(40%)	F	IP41
GTW9S-62P0A	630	2	≤80	Φ400	4×Φ10×16	18.3	420	192	51.2	8.4	32	S5(40%)	F	IP41
GTW9S-81P0A	800	1	≤80	Φ400	5×Φ10×16	12.1	502	96	25.6	5.0	32	S5(40%)	F	IP41
GTW9S-81P5A	800	1.5	≤80	Φ400	5×Φ10×16	18.8	530	144	38.4	8.0	32	S5(40%)	F	IP41
GTW9S-81P6A	800	1.6	≤80	Φ400	5×Φ10×16	18.8	530	153	40.8	8.5	32	S5(40%)	F	IP41
GTW9S-81P7A	800	1.75	≤80	Φ400	5×Φ10×16	20.7	530	167	44.5	9.3	32	S5(40%)	F	IP41
GTW9S-82P0A	800	2	≤80	Φ400	5×Φ10×16	23.2	530	192	51.2	10.7	32	S5(40%)	F	IP41
GTW9S-101P0A	1000	1	≤80	Φ400	5×Φ10×16	14.7	604	96	25.6	6.1	32	S5(40%)	F	IP41
GTW9S-101P5A	1000	1.5	≤80	Φ400	5×Φ10×16	22.9	650	144	38.4	9.8	32	S5(40%)	F	IP41
GTW9S-101P6A	1000	1.6	≤80	Φ400	5×Φ10×16	22.9	650	153	40.8	10.4	32	S5(40%)	F	IP41
GTW9S-101P7A	1000	1.75	≤80	Φ400	5×Φ10×16	25.1	650	167	44.5	11.4	32	S5(40%)	F	IP41
GTW9S-102P0A	1000	2	≤80	Φ400	5×Φ10×16	28.2	650	192	51.2	13.1	32	S5(40%)	F	IP41

► MODEL: YJ125

Suspension:1:1
 Max.Static Load : 2000kg
 Control : VVVF
 Brake : DC1101VA
 Weight : 195kg

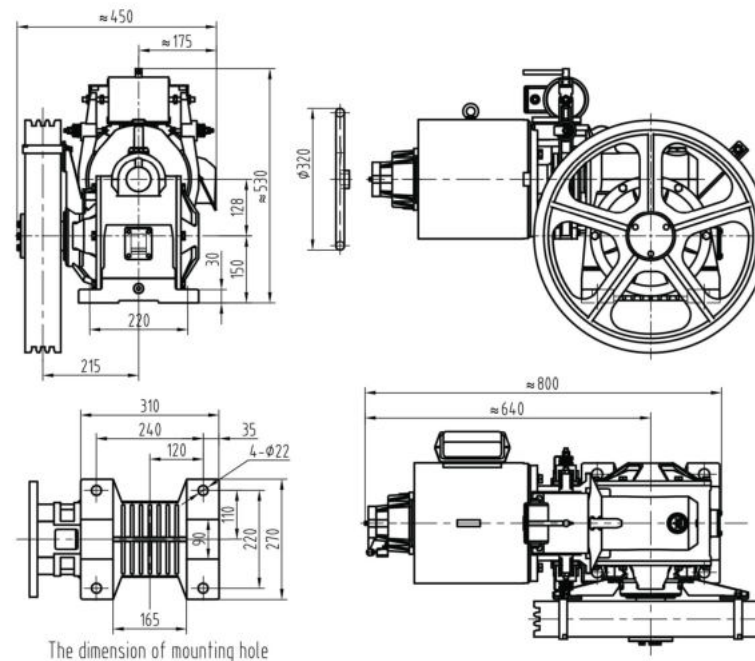

Load (kg)	Lift Speed (m/s)	Ratio	Sheave Diam (mm)	Rope Sheave (mm)	Motor Power (kW)	Pole
400	0.65	37:1	Φ520	3×Φ13×20	3	4
400	1	37:1	Φ520	3×Φ13×20	4	4

► MODEL: YJ250A

Suspension: 1:1
 Max. Static Load : 7000kg
 Control : VVVF
 Brake : DC1102VA
 Emergency Brake : AC220V 0.24/0.12A
 Weight : 710kg

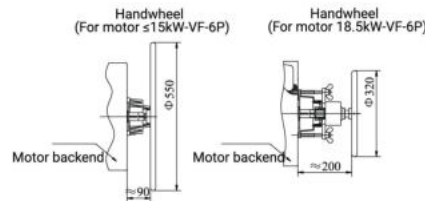
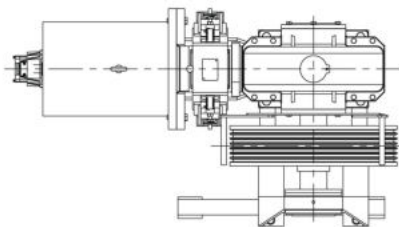
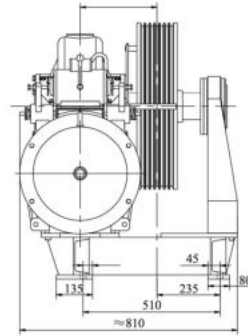
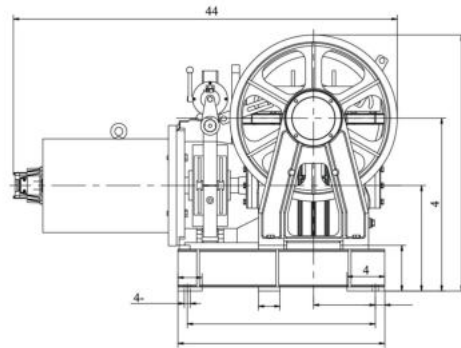

Load (kg)	Lift Speed (m/s)	Ratio	Sheave Diam (mm)	Rope Sheave (mm)	Motor Power (kW)	Pole
1500	1	63:2	Φ620	7×Φ13×18	15/18.5	6

► MODEL: YJ275A

Suspension: 1:1
 Max. Static Load : 9000kg
 Control : VVVF
 Brake : DC1102VA
 Emergency Brake : AC220V 0.24/0.12A
 Weight : 1000kg

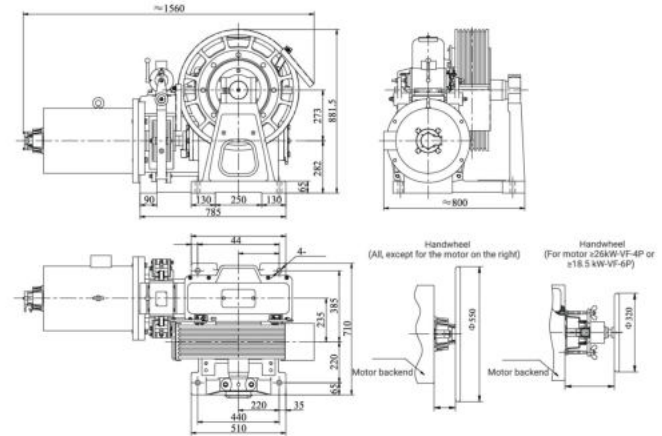

Load (kg)	Lift Speed (m/s)	Ratio	Sheave Diam (mm)	Rope Sheave (mm)	Motor Power (kW)	Pole
1150	0.5	59:1	Φ650	6×Φ13×20	7.5	6
1150	1	59:2	Φ650	6×Φ13×20	11	6
1150	1.25	49:2	Φ650	6×Φ13×20	15	6
1150	1.6	59:2	Φ650	8×Φ13×20	18.5	4
1150	1.75	57:2	Φ650	8×Φ13×20	18.5	4
1150	2	49:2	Φ650	8×Φ13×20	22	4
1250	0.5	59:1	Φ650	6×Φ13×20	7.5	6
1250	1	59:2	Φ650	6×Φ13×20	15	6
1250	1.6	59:2	Φ650	8×Φ13×20	22	4
1250	1.75	57:2	Φ650	8×Φ13×20	22	4
1250	2	49:2	Φ650	8×Φ13×20	26	4
1350	0.5	59:1	Φ650	6×Φ13×20	7.5	6
1350	1	59:2	Φ650	6×Φ13×20	15	6
1350	1.6	59:2	Φ650	8×Φ13×20	22	4
1350	1.75	57:2	Φ650	8×Φ13×20	22	4
1350	2	49:2	Φ650	8×Φ13×20	26	4
1600	0.5	59:1	Φ650	8×Φ13×20	11	6
1600	1	59:2	Φ650	8×Φ13×20	18.5	6
1600	1.6	59:2	Φ650	8×Φ13×20	26	4
1600	1.75	57:2	Φ650	8×Φ13×20	26	4
1600	2	49:2	Φ650	8×Φ13×20	30	4

► MODEL: FJE-C



OPTION	Model Series	Voltage	Power range	Origin
White	FJE-C	4: 3 Phase 380V	008: 8.3kW	K: KOREA
Green			017: 17kW	
			022: 22kW	
			037: 37kW	



MCTC-CTW-B3S



MCTC-COB-B1S



MCTC-HCB-R602S



MCTC-HCB-D735S



MCTC-HCB-D635S



MCTC-HCB-D635SX

► MODEL: FJE325

Traction Ratio: 2:1
 Rated capacity: 320 - 500kg
 Rated elevator speed: 0.63, 1.0, 1.6, 1.75m/s
 Max. shaft load: 2200kg
 Applicable converter: 3 Phase 400V
 Brake voltage: DC110V
 Number of motor poles: 20 poles
 Insulation: F

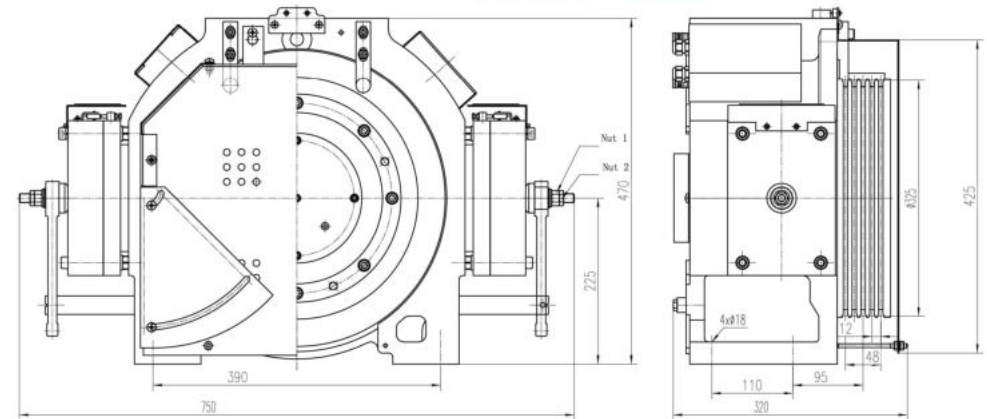
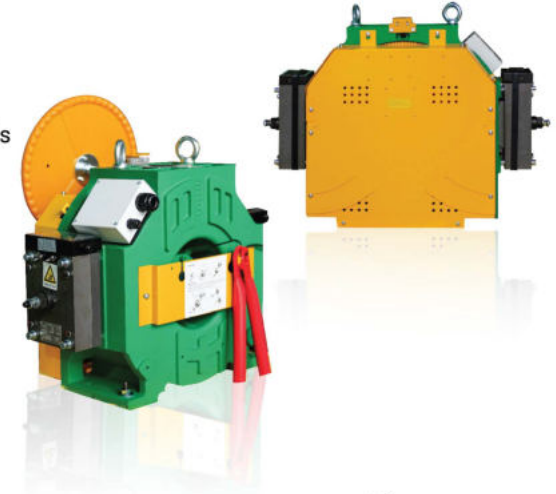

FJE325 - N320/500 ELEVATOR TRACTION MACHINE (ROPPING 2:1)

Capacity (kg)	Elev Speed (m/s)	Rated Output (kW)	Rated Current (A)	Rated Speed (rpm)	Frequency (Hz)	Sheave Diameter (mm)	Poles (2p)	Torque (N.m)	Ropes	Weight (kg)	Load (kg)	Traction Ratio
320	0.63	1.3	3.8	73.8	12.3	325	32	170	3 x φ8 x 12	220	320	2:1
320	1.0	2.1	5.6	117	19.5	325	32	170	3 x φ8 x 12			
320	1.6	3.2	6.5	187.8	31.3	325	32	170	3 x φ8 x 12			
500	0.63	2	4.8	73.8	12.3	325	32	260	4 x φ8 x 12	235	500	
500	1.0	3.2	6.8	117	19.5	325	32	260	4 x φ8 x 12			
500	1.6	5.2	11.2	187.8	31.3	325	32	260	4 x φ8 x 12			

▶ MODEL: FJE400

Traction Ratio: 2:1

Rated capacity: 630 - 1000kg

Rated elevator speed: 0.63, 1.0, 1.6, 1.75m/s

Brake electric current: 2 x 1.35A

Applicable converter: 3 Phase 400V

Brake voltage: DC110V

Number of motor poles: 32 poles

Insulation: F

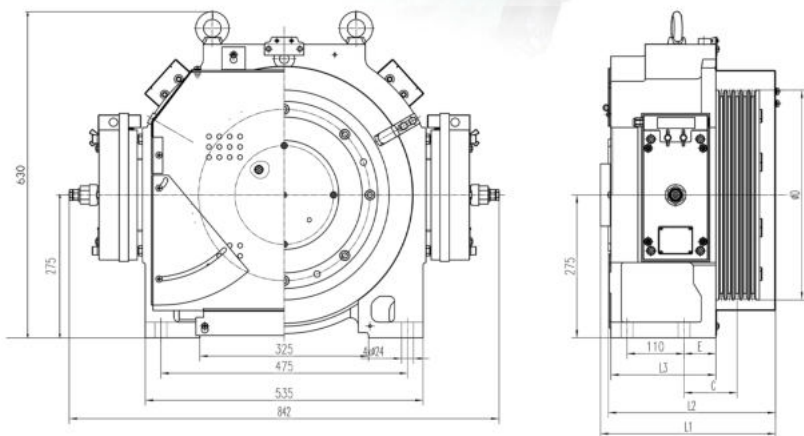

MAX(kg)	L1	L2	L3	C	D	E	B
630	340	305	204	102	400	61	15
800	340	305	204	102	400	61	15
1000	340	305	204	102	400	61	15
1150	355	330	217	111.5	400	63	15

FJE400 - N630/1000 ELEVATOR TRACTION MACHINE

Capacity (kg)	Elevator Speed (m/s)	Rated Speed (rpm)	Frequency (Hz)	Sheave Diameter (mm)	Poles (2p)	Torque (N.m)	Ropes	Weight (kg)	Rated Output (kW)	Load (kg)	Traction Ratio
630	0.63	60	16	400	32	420	4xΦ10	330	2.6	630	2:1
630	1.0	96	25.6	400	32	420	4xΦ10	330	4.2	630	2:1
630	1.6	153	40.8	400	32	420	4xΦ10	330	6.7	630	2:1
630	1.75	167	44.5	400	32	420	4xΦ10	330	7.3	630	2:1
630	2.0	192	51.2	400	32	420	4xΦ10	330	8.4	630	2:1
800	0.63	60	16	400	32	530	5xΦ10	330	3.3	630	2:1
800	1.0	96	25.6	400	32	530	5xΦ10	330	5.3	630	2:1
800	1.6	153	40.8	400	32	530	5xΦ10	330	8.5	630	2:1
800	1.75	167	44.5	400	32	530	5xΦ10	330	9.3	630	2:1
800	2.0	192	51.2	400	32	530	5xΦ10	330	10.7	630	2:1
1000	0.63	60	16	400	32	650	5xΦ10	350	4.1	1000	2:1
1000	1.0	96	25.6	400	32	650	5xΦ10	350	6.5	1000	2:1
1000	1.6	153	40.8	400	32	650	5xΦ10	350	10.4	1000	2:1
1000	1.75	167	44.5	400	32	650	5xΦ10	350	11.4	1000	2:1
1000	2.0	192	51.2	400	32	650	5xΦ10	350	13.1	1000	2:1
1150	0.63	60	16	400	32	756	6xΦ10	360	4.7	1150	2:1
1150	1.0	96	25.6	400	32	756	6xΦ10	360	7.6	1150	2:1
1150	1.6	153	40.8	400	32	756	6xΦ10	360	12.1	1150	2:1
1150	1.75	157	44.5	400	32	756	6xΦ10	360	13.2	1150	2:1
1150	2.0	192	51.2	400	32	756	6xΦ10	360	15.2	1150	2:1

▶ MODEL: FJE200

Voltage: 220V/ 380V

Roping: 2:1/ 1:1

Wrap: Single

Wlv. Load: 320 ~ 450kg

Elv. Speed: 0.4m/s

Sheave Diam: 200mm/ 240mm

Duty: S5 - 40% ED

Starts Per Hour: 180st/h

Max. Static Load: 2500kg

Weight: 160kg

Brake: DC110V 2.5A

IP Code: IP41

Ins. Class: F

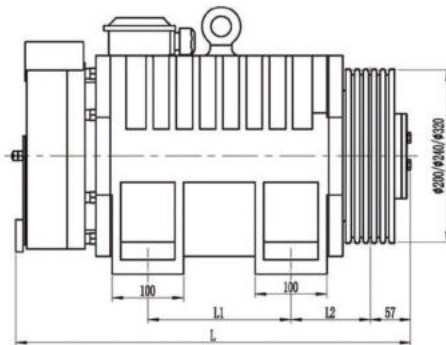
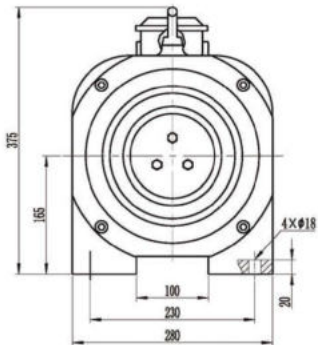

Type	Roping	Spec	Elv Load kg	Elv Speed m/s	Sheave Dia mm	Sheave Groove	Voltage V	Current A	Power kW	Speed r/min	Freq Hz	Torque N·m	Poles	mm	mm	mm	Undercut Angle °
FJE200	2:1	320-0.4A	320	0.4	200	3 x φ x 12	220 380	4 2	0.9	76	15.2	110	24	430	100	100.5	90
FJE200		400-0.4A	400	0.4	200	4 x φ x 12	220 380	5 3	1.1	76	15.2	140	24	430	100	100.5	
FJE200		450-0.4A	450	0.4	200	4 x φ x 12	220 380	6 4	1.2	76	15.2	150	24	430	100	100.5	
FJE200		320-0.4B	320	0.4	240	3 x φ x 12	220 380	5 3	0.9	64	12.8	130	24	430	100	100.5	
FJE200		400-0.4B	400	0.4	240	4 x φ x 12	220 380	6 3	1.1	64	12.8	160	24	430	100	100.5	
FJE200		450-0.4B	450	0.4	240	4 x φ x 12	220 380	7 5	1.2	64	12.8	180	24	430	100	100.5	
FJE200		320-0.4C	320	0.4	200	4 x φ x 12	220 380	5 3	0.9	38	5.1	220	16	520	150	110.5	
FJE200		400-0.4C	400	0.4	200	5 x φ x 12	220 380	6 4	1.1	38	5.1	270	16	520	150	110.5	
FJE200		450-0.4C	450	0.4	200	5 x φ x 12	220 380	7 5	1.2	38	5.1	300	16	520	150	110.5	
FJE200		320-0.4D	320	0.4	240	4 x φ x 12	220 380	6 4	0.9	32	4.3	260	16	520	150	110.5	
FJE200		400-0.4D	400	0.4	240	5 x φ x 12	220 380	7 5	1.1	32	4.3	320	16	520	150	110.5	
FJE200		450-0.4D	450	0.4	240	5 x φ x 12	220 380	8 6	1.2	32	4.3	360	16	570	200	110.5	
FJE200		320-0.5A	320	0.5	320	3 x φ x 12	380	4	1.1	60	12	170	24	430	100	100.5	
FJE200		320-0.63A	320	0.63	320	3 x φ x 12	380	4	1.3	75	15	170	24	430	100	100.5	
FJE200		320-1.0A	320	1.0	320	3 x φ x 12	380	6	2.1	119	23.8	170	24	430	100	100.5	
FJE200		400-0.5A	400	0.5	320	4 x φ x 12	380	5	1.4	60	12	220	24	520	150	110.5	
FJE200		400-0.63A	400	0.63	320	4 x φ x 12	380	5	1.7	75	15	220	24	520	150	110.5	
FJE200		400-1.0A	400	1.0	320	4 x φ x 12	380	8	2.7	119	23.8	220	24	520	150	110.5	
FJE200		450-0.5A	450	0.5	320	4 x φ x 12	380	6	1.5	60	12	240	24	520	150	110.5	
FJE200		450-0.63A	450	0.63	320	4 x φ x 12	380	6	1.9	75	15	240	24	520	150	110.5	
FJE200		450-1.0A	450	1.0	320	4 x φ x 12	380	9	3	119	23.8	240	24	520	150	110.5	
FJE200		630-0.5A	630	0.5	320	5 x φ x 12	380	8	2.1	60	12	340	24	570	200	110.5	
FJE200		630-0.63A	630	0.63	320	5 x φ x 12	380	8	2.7	75	15	340	24	570	200	110.5	
FJE200		630-1.0A	630	1.0	320	5 x φ x 12	380	11	4.2	119	23.8	340	24	570	200	110.5	
FJE200	630-1.5A	630	1.5	320	5 x φ x 12	380	16	6.4	179	35.8	340	24	570	200	110.5		

► MODEL: FJT-C



Rate power	2.2KW - 15KW	18.5KW - 22KW	30KW - 37KW	5.5KW - 22KW
Rate speed	≤ 2.5m/s	≤ 4m/s		≤ 2.5m/s
Inverter				
Power supply				
Motor brake voltage	DC110V			
Machineroom	Machine room type			
Motor type	Synchronous or asynchronous			
Cabinet material	Galvanized box			
Package	Wooden box			
Installation	Ground mounted			



MCTC - CTB A



MCTC - CCB



MCTC - CTB B



MCTC - HCB B



MCTC - CTB B



MCTC - HCB - H



MCTC - HCB - T1



MCTC - HCB - D2

► MODEL: FJT320

- Rated Voltage: AC 380V
- Brake Voltage: DC 110V
- Compact structure, smaller size, applicable to various machine rooms;
- Self- sealing bearing, bearing life is long;
- Low vibration, low noise, good comfort;
- Epoxy resin casting process, better heat dissipation, better dust resistance better shock resistance.

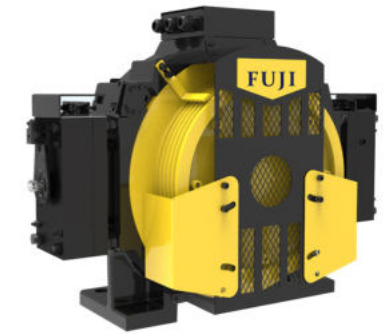

• B450 DIMENSION DRAWING

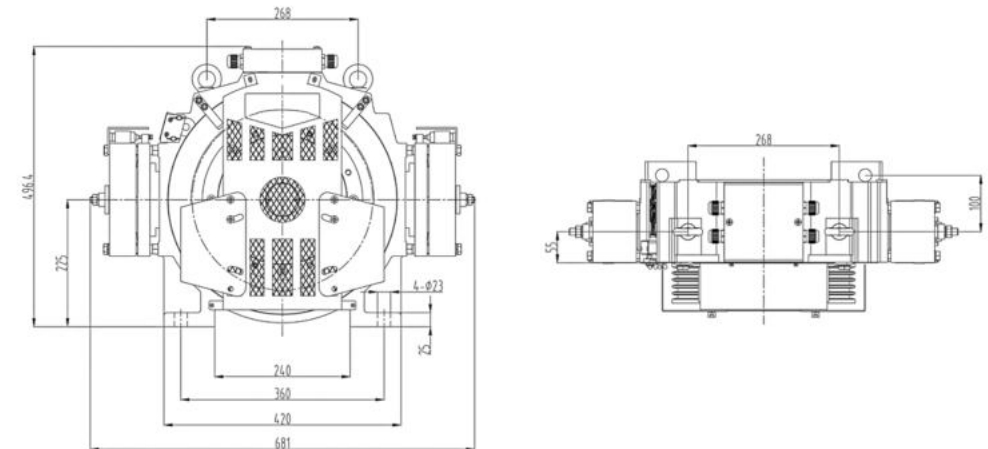

• B450 ELEVATOR TRACTION MACHINE (ROPING 2:1)

Capacity (kg)	Elevator Speed (m/s)	Rated Power (kW)	Rated Current (A)	Rated Speed (rpm)	Frequency (Hz)	Sheave Diameter (mm)	Poles (2p)	Torque (N.m)	Ropes	Trace Ratio
450	0.5	1.5	5.5	60	14	320	28	239	4xΦ8	2:1
450	1	3.3	8.5	119	27.8	320	28	241	4xΦ8	2:1
450	1.5	4.3	11	179	41.8	320	28	229	4xΦ8	2:1
450	2	4.6	11	191	44.6	320	28	230	4xΦ8	2:1

► MODEL: FJT400

- Rated Voltage: AC 380V
- Brake Voltage: DC 110V
- Compact structure, smaller size, applicable to various machine rooms;
- Self-sealing bearing, bearing life is long;
- Low vibration, low noise, good comfort;
- Epoxy resin casting process, better heat dissipation, better dust resistance better shock resistance.

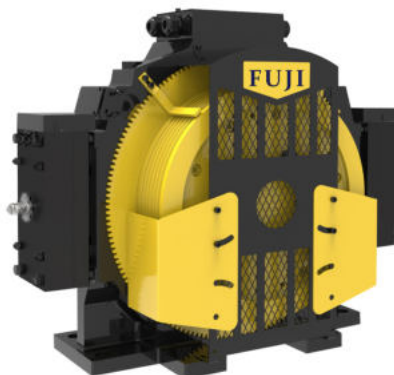

• B630/1050 DIMENSION DRAWING

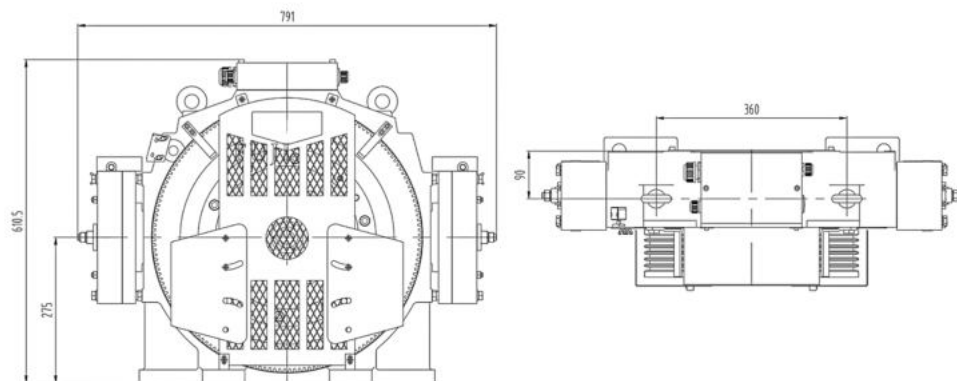

• B630/1050 ELEVATOR TRACTION MACHINE (ROPING 2:1)

Capacity (kg)	Elevator Speed (m/s)	Rated Power (kW)	Rated Current (A)	Rated Speed (rpm)	Frequency (Hz)	Sheave Diameter (mm)	Poles (2p)	Torque (N.m)	Ropes	Trace Ratio
630	1.0	4.2	11	96	32	400	40	333	4xΦ10	2:1
630	1.5	6	15.5	144	48	400	40	332	4xΦ10	2:1
630	2.0	7	17	192	64	400	40	332	4xΦ10	2:1
800	1.0	5.0	13.7	96	32	400	40	498	5xΦ10	2:1
800	1.5	7.8	20	144	48	400	40	517	5xΦ10	2:1
800	2.0	10.5	26.5	192	64	400	40	522	5xΦ10	2:1
1000	1.0	6.15	17.1	96	32	400	40	612	5xΦ10	2:1
1000	1.5	9.2	24.3	144	48	400	40	610	5xΦ10	2:1
1000	2.0	12.3	31	192	64	400	40	612	5xΦ10	2:1
1050	1.0	6.4	17.8	96	32	400	40	637	5xΦ10	2:1
1050	1.5	9.7	25.2	144	48	400	40	642	5xΦ10	2:1
1050	2.0	12.9	32.7	192	64	400	40	633	5xΦ10	2:1

▶ MODEL: FJE100

Voltage	380V
Roping	2:1
Wrap	(Single)
Elv. Load	(320 ~ 630) kg
Elv. Speed	(0.5 ~ 1.75) m/s
Sheave Diam	320mm
Duty	S5 - 40%ED
Starts Per Hour	240st/h
Max. Static Load	2500kg
Weight	250kg
Brake	DC110V 2×1.3A
IP Code	IP41
Ins. Class	F

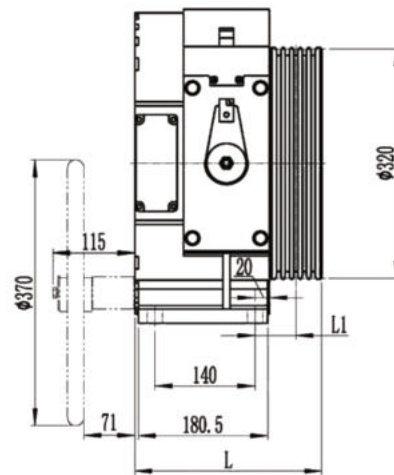
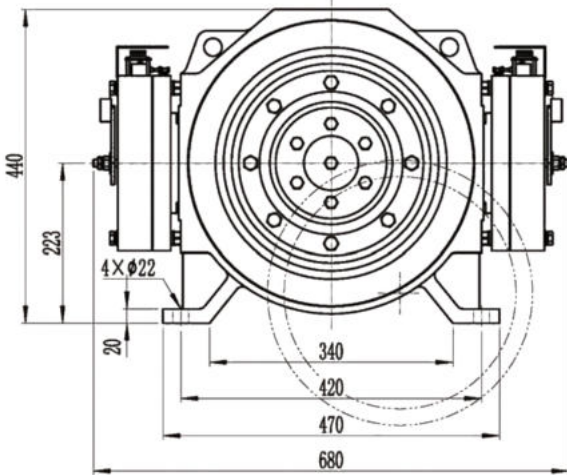
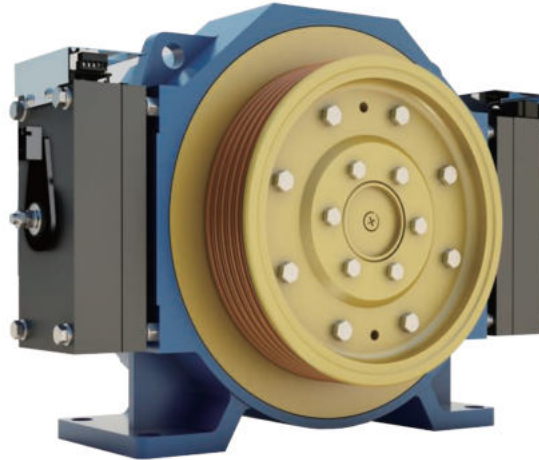

Type	Spec	Elv Load	Elv Speed	Sheave Dia	Sheave Groove	Current	Power	Speed	Freq	Torque	Poles			Undercut Angle
		kg	m/s	mm		A	kW	r/min	Hz	N·m		mm	mm	°
FJE100	320-0.5A	320	0.5	320	3×Φ8×12	3	1.1	60	10.0	180	20	251	52	95
FJE100	320-0.63A	320	0.63	320	3×Φ8×12	3	1.4	75	12.5	180	20	251	52	
FJE100	320-1.0A	320	1.0	320	3×Φ8×12	5	2.2	119	19.8	180	20	251	52	
FJE100	320-1.5A	320	1.5	320	3×Φ8×12	8	3.4	179	29.8	180	20	251	52	
FJE100	450-0.5A	450	0.5	320	4×Φ8×12	5	1.5	60	10.0	240	20	251	52	
FJE100	450-0.63A	450	0.63	320	4×Φ8×12	5	1.9	75	12.5	240	20	251	52	
FJE100	450-1.0A	450	1.0	320	4×Φ8×12	7	3	119	19.8	240	20	251	52	
FJE100	450-1.5A	450	1.5	320	4×Φ8×12	11	4.5	179	29.8	240	20	251	52	
FJE100	450-1.75A	450	1.75	320	4×Φ8×12	11	5.3	209	34.8	240	20	251	52	
FJE100	630-0.5A	630	0.5	320	5×Φ8×12	7	2.1	60	10.0	340	20	261	57	
FJE100	630-0.63A	630	0.63	320	5×Φ8×12	7	2.7	75	12.5	340	20	261	57	
FJE100	630-1.0A	630	1.0	320	5×Φ8×12	10	4.2	119	19.8	340	20	261	57	
FJE100	630-1.5A	630	1.50	320	5×Φ8×12	16	6.4	179	29.8	340	20	261	57	
FJE100	630-1.6A	630	1.6	320	5×Φ8×12	16	6.8	191	31.8	340	20	261	57	
FJE100	630-1.75A	630	1.75	320	5×Φ8×12	16	7.4	209	34.8	340	20	261	57	

► MODEL: FJE200

Voltage	380V
Roping	2:1
Wrap	(Single)
Elv. Load	(630 ~ 1150)kg
Elv. Speed	(0.5 ~ 2.5)m/s
Sheave Diam	400mm/450mm
Duty	S5 - 40%ED
Starts Per Hour	240st/h
Max. Static Load	4000kg
Weight	350kg
Brake	DC110V 2×1.3A
IP Code	IP41
Ins. Class	F

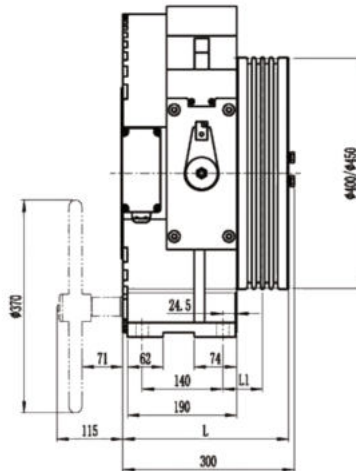
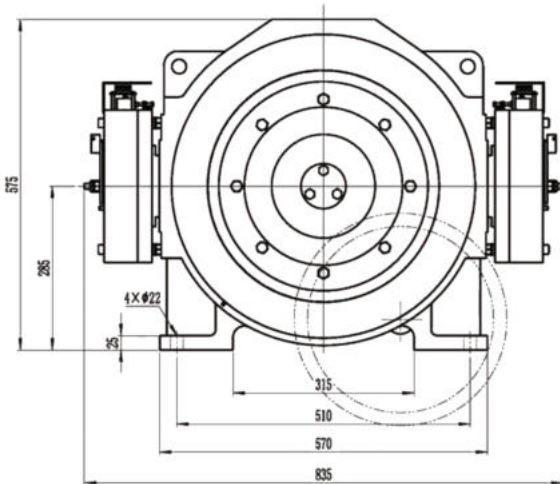
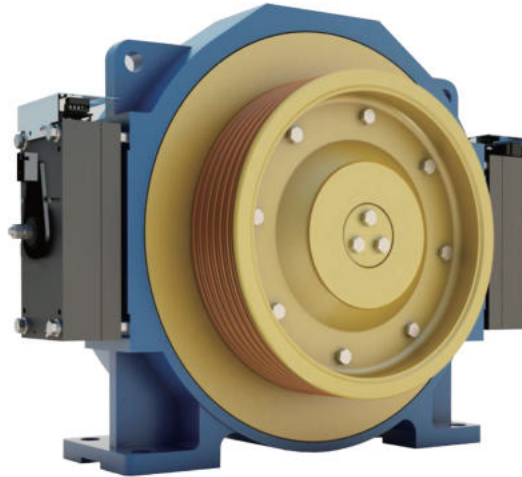

Type	Spec	Elv Load	Elv Speed	Sheave Dia	Sheave Groove	Current	Power	Speed	Freq	Torque	Poles			Undercut Angle
		kg	m/s	mm		A	kW	r/min	Hz	N·m		mm	mm	°
FJE200	630-0.5A	630	0.5	400	4×Φ10×15	6	2.2	48	12.8	430	32	288	69.5	95
FJE200	630-0.63A	630	0.63	400	4×Φ10×15	6	2.7	60	16.0	430	32	288	69.5	
FJE200	630-1.0A	630	1.0	400	4×Φ10×15	10	4.3	95	25.3	430	32	288	69.5	
FJE200	630-1.5A	630	1.5	400	4×Φ10×15	14	6.4	143	38.1	430	32	288	69.5	
FJE200	630-1.6A	630	1.6	400	4×Φ10×15	16	6.9	153	40.8	430	32	288	69.5	
FJE200	630-1.75A	630	1.75	400	4×Φ10×15	16	7.5	167	44.5	430	32	288	69.5	
FJE200	630-2.0A	630	2.0	400	4×Φ10×15	18	8.6	191	50.9	430	32	288	69.5	
FJE200	630-2.0B	630	2.0	450	4×Φ10×15	18	8.5	170	45.3	480	32	288	69.5	
FJE200	800-0.5A	800	0.5	400	5×Φ10×15	8	2.7	48	12.8	540	32	288	69.5	
FJE200	800-0.63A	800	0.63	400	5×Φ10×15	8	3.4	60	16.0	540	32	288	69.5	
FJE200	800-1.0A	800	1.0	400	5×Φ10×15	12	5.4	95	25.3	540	32	288	69.5	
FJE200	800-1.5A	800	1.5	400	5×Φ10×15	18	8.1	143	38.1	540	32	288	69.5	
FJE200	800-1.6A	800	1.6	400	5×Φ10×15	20	8.7	153	40.8	540	32	288	69.5	
FJE200	800-1.75A	800	1.75	400	5×Φ10×15	20	9.4	167	44.5	540	32	288	69.5	
FJE200	800-2.0A	800	2.0	400	5×Φ10×15	23	10.8	191	50.9	540	32	288	69.5	
FJE200	800-2.0B	800	2.0	450	5×Φ10×15	23	10.7	170	45.3	600	32	288	69.5	
FJE200	800-2.5A	800	2.5	400	6×Φ10×15	28	13.5	239	63.7	540	32	300	75.5	
FJE200	800-2.5B	800	2.5	450	5×Φ10×15	29	13.3	212	56.5	600	32	288	69.5	
FJE200	1000-0.5A	1000	0.5	400	5×Φ10×15	10	3.4	48	12.8	670	32	288	69.5	
FJE200	1000-0.63A	1000	0.63	400	5×Φ10×15	10	4.2	60	16.0	670	32	288	69.5	
FJE200	1000-1.0A	1000	1.0	400	5×Φ10×15	15	6.7	95	25.3	670	32	288	69.5	
FJE200	1000-1.5A	1000	1.5	400	5×Φ10×15	23	10.0	143	38.1	670	32	288	69.5	
FJE200	1000-1.6A	1000	1.6	400	5×Φ10×15	26	10.7	153	40.8	670	32	288	69.5	
FJE200	1000-1.75A	1000	1.75	400	5×Φ10×15	26	11.7	167	44.5	670	32	288	69.5	
FJE200	1000-2.0A	1000	2.0	400	5×Φ10×15	28	13.4	191	50.9	670	32	288	69.5	
FJE200	1000-2.0B	1000	2.0	450	5×Φ10×15	28	13.4	170	45.3	750	32	288	69.5	
FJE200	1000-2.5A	1000	2.5	400	6×Φ10×15	34	16.8	239	63.7	670	32	300	75.5	
FJE200	1000-2.5B	1000	2.5	450	6×Φ10×15	36	16.6	212	56.5	750	32	300	75.5	
FJE200	1150-0.5A	1150	0.5	400	5×Φ10×15	12	3.9	48	12.8	780	32	288	69.5	
FJE200	1150-0.63A	1150	0.63	400	5×Φ10×15	12	4.9	60	16.0	780	32	288	69.5	
FJE200	1150-1.0A	1150	1.0	400	5×Φ10×15	17	7.8	95	25.3	780	32	288	69.5	
FJE200	1150-1.5A	1150	1.5	400	6×Φ10×15	29	11.7	143	38.1	780	32	300	75.5	
FJE200	1150-1.6A	1150	1.6	400	6×Φ10×15	29	12.5	153	40.8	780	32	300	75.5	
FJE200	1150-1.75A	1150	1.75	400	6×Φ10×15	29	13.6	167	44.5	780	32	300	75.5	
FJE200	1150-2.0A	1150	2.0	400	6×Φ10×15	33	15.6	191	50.9	780	32	300	75.5	

► MODEL: HDO - 01V

• **Product Name:** 2 Panels Center Opening Door Operator (VVVF)

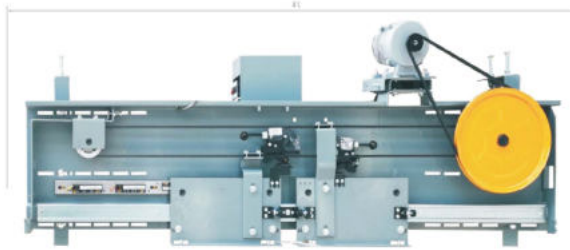

JJ	600	650	700	750	800	850	900	950	1000	1050	1100	1150	1200
A1L	1260	1360	1460	1560	1660	1760	1860	1960	2060	2160	2260	2320	2420

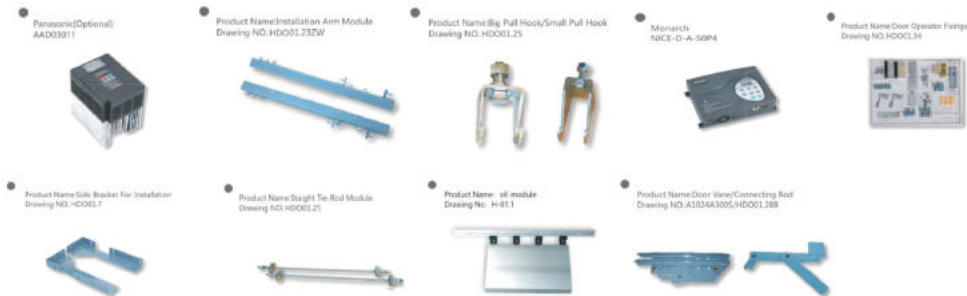

► MODEL: HLD - 01T

• **Product Name:** 2 Panels Center Opening Door Device (Traditional Type)

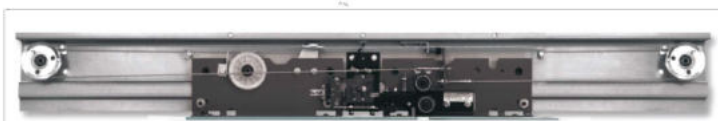

JJ	600	650	700	750	800	850	900	950	1000	1050	1100	1150	1200	1250	1300
A1L	1240	1340	1440	1540	1640	1740	1840	1940	2040	2140	2240	2340	2440	2540	2640

► MODEL: OMJ - 100B

• **Product Name:** Leafs Center Opening Permanent Magnet Synchronous Door Operator



JJ	600	650	700	750	800	850	900	950	1000	1050	1100	1150	1200
A1L	1180	1280	1380	1480	1580	1680	1780	1880	1980	2080	2180	2280	2380
A3L	175	200	225	250	275	300	325	350	375	400	425	450	475
B2L	890/1020	940/1070	990/1120	1040/1170	1090/1220	1140/1270	1190/1320	1240/1370	1290/1420	1340/1470	1390/1520	1440/1570	1490/1620

Inverter(Optional):



Installation Attachment:



► MODEL: HGO 240

• **Product Name:** HGO 240 Governor Non - Return

Technical: Specifications

Rated capacity: 630 - 1000kg

Rated speed: $V = 0/25 \sim 2.5\text{m/s}$

Rope Dia: $\phi 8\text{mm}$

Sheavediameter: $\phi 240\text{mm}$

Rope tension Force: 500 ~ 1500N

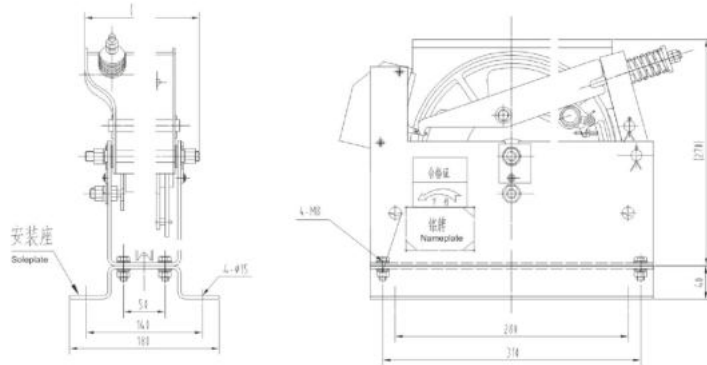

• **Description:**

This Governor For Configuration Of Gearless Traction Machine
This Governor Is Adapted To HTD240, HTD260 Tensioning Device



• **Technical Parameters**

1	HGO 240.20	Wire Rope Fittings		1
2		Wire Rope Fittings		2
3		Retainer Clip	Φ8	6
4	GB/T5783	Hexagon Bolt	M8	4
5		Expansion Bolt	M12x100	4

► PRODUCT NAME: HTD260/260A

• **Product Name:** HGO 240 Governor Non - Return

• **Description:**

A Heavy Block 11kg Suitable For Lifting Beight Of Lift $\leq 60\text{m}$

A Heavy Block 16kg Suitable For Lifting Beight Of Lift $> 60\text{m}$

This Tension Device For The Weights Of The Side - Mounted And B Siez Adjustable

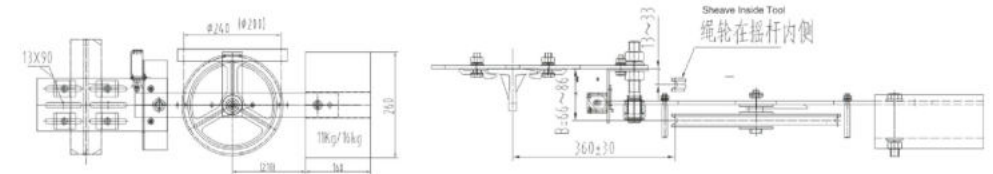

► PRODUCT NAME: HTD240

• **Description:**

A Heavy Block 11kg Suitable For Lifting Beight Of Lift $\leq 60\text{m}$

A Heavy Block 16kg Suitable For Lifting Beight Of Lift $> 60\text{m}$

This Tension Device For The Heavy Piece Of Straight Type

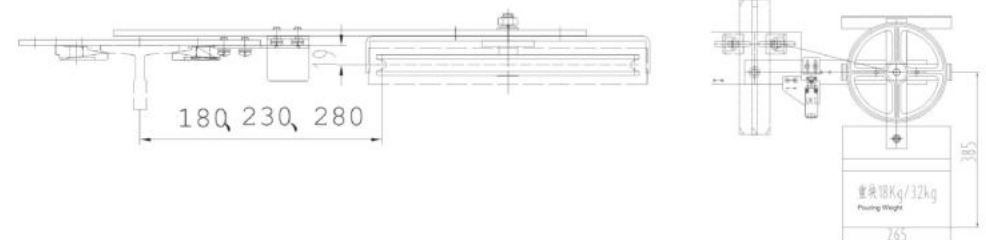



▶ PRODUCT NAME: HSG - 800

• Technical Specifications:

Rated Speed: $V = 0.25 \sim 2.5\text{m/s}$
 (P + Q) Allowable gross mass (P + Q): 1200 ~ 4000kg
 Width Guide Rails: 10, 16mm

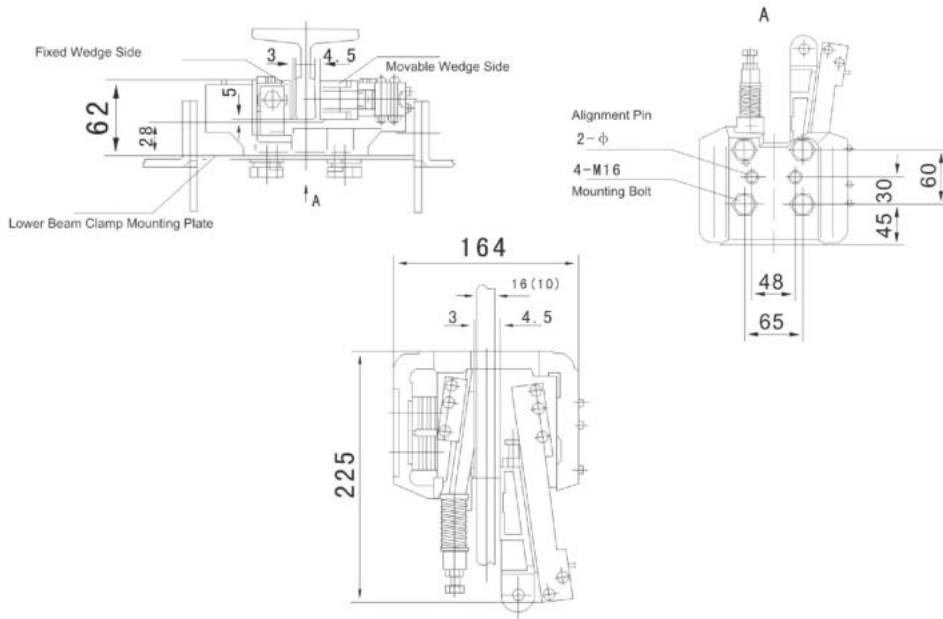

• List Of Attachments

	Part name	Size	Quantity
1	Safety		1
2	Tappet		1
3	Torsional Spring		1
4	Elastic Cylindrical Pin	12x40	4
5	Pin Roll		2
6	Switch To Play Pole		1
7	Adjusting Shim		2
8	Cotter Pin	3x20	4
9	Gasket		2

▶ MODEL: QSD

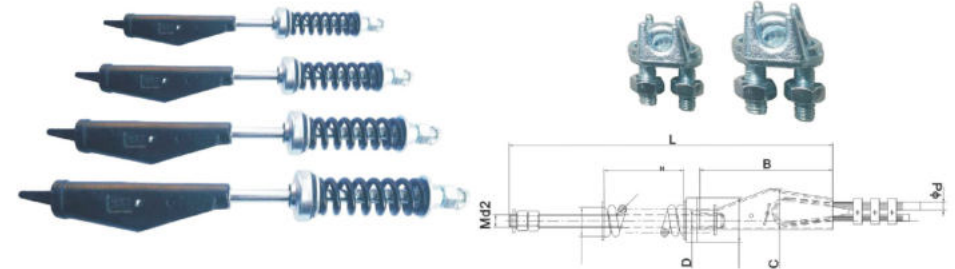

Model number	Specification Of Wire Rope	Length	Length Of Taper Bushes	Width Of Taper Bushes	Installation	Screw nut
HRF8	∅ 8	375	160	48	∅ 26	M14
HRF9	∅ 9.3	395	180	54	∅ 26	M14
HRF10	∅ 10	490	180	54	∅ 26	M16
HRF11	∅ 11	490	180	54	∅ 26	M16
HRF12	∅ 12	510	200	60	∅ 26	M16
HRF13	∅ 13	580	218	62	∅ 30	M18
HRF16	∅ 16	620	190	76	∅ 22	M20

▶ GUIDE SHOE

• Product Name: Guide Shoe (Hollow Track)

Serial NO: HSG09191

Technical Parameters

Rated Speed $\leq 2.0\text{m/s}$

Guide Rail Width 10, 16mm

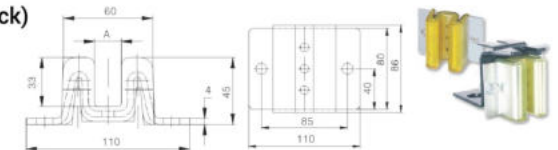

• Product Name: Guide Shoe (Hollow Track)

Serial NO: HSG09192

Technical Parameters

Rated Speed $\leq 2.0\text{m/s}$

Guide Rail Width 10, 16mm

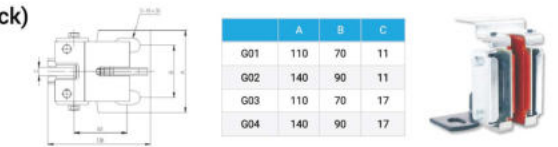

• Product Name: Guide Shoe (Hollow Track)

Serial NO: HSG09193

Technical Parameters

Rated Speed $\leq 2.0\text{m/s}$

Guide Rail Width 10, 16mm

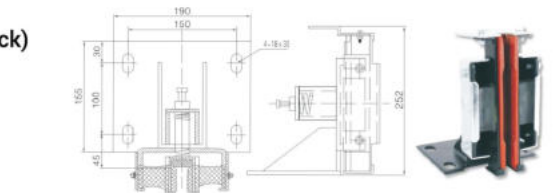



► FJ STEEL WIRE ROPE

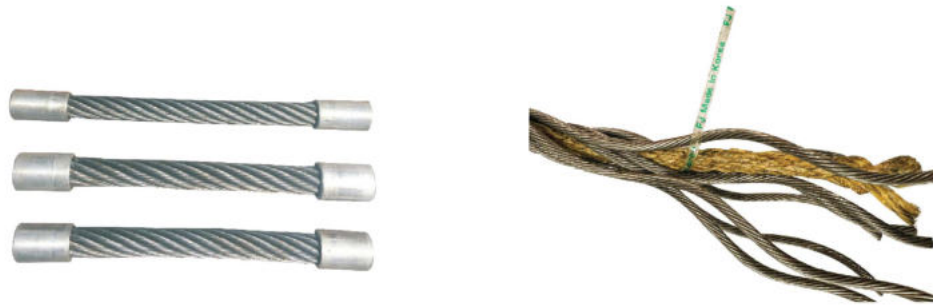

• FJ - 8X19S - Hemp Core

Rope Diameter	Minimum Breaking Force	Unit Weight	Metal Sectional Area
8*	31.6	22.2	23
9	40	28.1	29.6
10*	49.4	34.7	36.5
11*	59.7	42	44.2
12	71.1	50	52.6
13*	83.4	58.6	61.7
16*	126	88.8	93.5

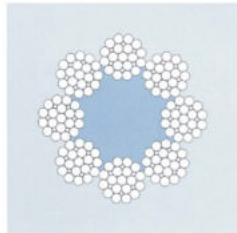

► MODEL: WECO

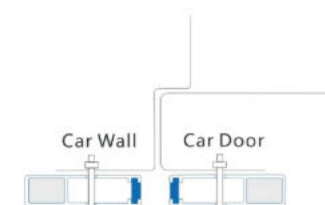
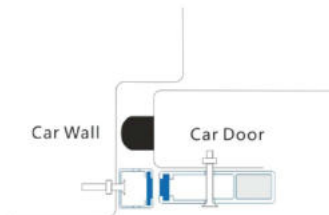
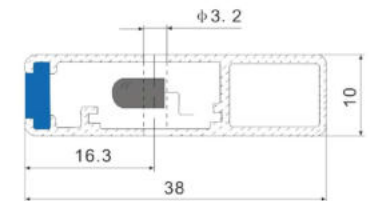
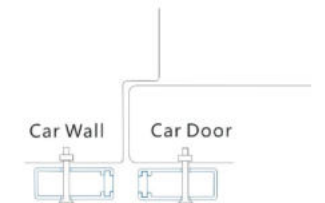
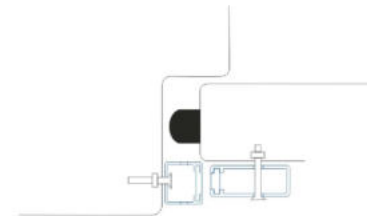
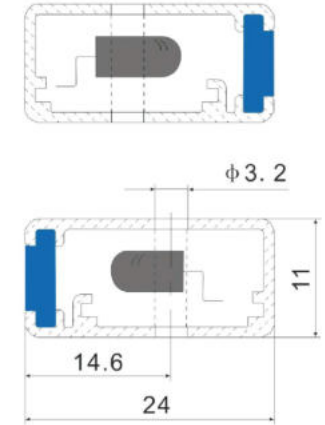

► ELEVATOR GUIDE RAIL



• Technical Parameters

Type	ISO	b1	h1	h	k	n	c	g	f	rs	m1	m2	t1	t2	l	d	d1	b3	l2	l3	
	Code	mm	mm	mm	mm	mm	mm	mm	mm	mm	mm	mm	mm	mm	mm	mm	mm	mm	mm	mm	mm
Tolerances		±1.5	±0.75	±0.1	±0.1/0	±3/0		±0.75	±0.75		±0.06/0	±0/-0.06	±0.1	±0.1	±3/0			±0.2	±0.2	±0.2	
RP70	T70-1/B	70	65	64	9	34	6	6	8	1.5	3	2.95	3.5	3	128	13	26	42	105	25	
RP75	T75-3/B	75	62	61	10	30	8	7	9	3	3	2.95	3.5	3	123	13	26	43	90	30	
RP78		78	56	55	10	26	7	6	8.5	3	3	2.95	3.5	3	123	13	26	43	90	30	
RP82	T82/B	82.5	68.3	66.6	9	25.4	7.5	6	8.25	3	3	2.95	3.5	3	111	13	26	50.8	81	27	
RP89	T89/B	89	62	61	15.88	33.4	10	7.9	11.1	3	6.4	6.37	7.14	6.35	156	13	26	57.2	114.3	38.1	
RP89-1	T89-1/B	89	62	61	15.88	33.4	10	7	10	3	3	2.95	4	3.5	156	13	26	57.2	114.3	38.1	
RP90	T90/B	90	75	74	16	42	10	8	10	4	6.4	6.37	7.14	6.35	156	17	26	57.2	114.3	38.1	
RP114		114	88.9	88	15.88	38	9.5	7.9	11.1	4	6.4	6.37	7.14	6.35	156	17	33	79.4	114.3	38.1	
RP125	T125/B	125	82	81	16	42	10	9	12	4	6.4	6.37	7.14	6.35	156	17	33	79.4	114.3	38.1	
RP127-1	T127-1/B	127	88	88	15.88	44.5	10	7.9	11.1	4	6.4	6.37	7.14	6.35	156	17	33	79.4	114.3	38.1	
RP127-2	T127-2/B	127	88.9	88	15.88	50.8	10	12.7	15.9	5	6.4	6.37	7.14	6.35	156	17	33	79.4	114.3	31.8	
RP140-1	T140-1/B	140	108	107	19	50.8	12.7	12.7	15.9	5	6.4	6.37	7.14	6.35	193	21	40	92.1	152.4	31.8	
RP140-2	T140-2/B	140	102	101	28.6	50.8	17.5	14.5	17.5	5	6.4	6.37	7.14	6.35	193	21	40	92.1	152.4	31.8	
RP140-3	T140-3/B	140	127	126	31.75	57.2	19	17.5	25.4	5	6.4	6.37	7.14	6.35	193	21	40	92.1	152.4	31.8	

• Guide Rail Technical Parameters

Tk3	Hollow Guide Rail	75mm*55mm*10mm	220*72*40mm	M8*25	5K
Tk3A	Hollow Guide Rail	78mm*60mm*16.4mm	200*78*50mm	M10*35	5K
Tk5	Hollow Guide Rail	87mm*60mm*16.4mm	400*88*59mm	M12*35	5K
Tk5A	Hollow Guide Rail	78mm*60mm*16.4mm	200*78*50mm	M8*25	5K
T45/A	Cold Draw Guide Rail	45mm*45mm*5mm	160*50*8mm	M8*25	T1
T50/A	Cold Draw Guide Rail	50mm*50mm*16.4mm	200*50*8mm	M12*35	T1
T70/A	Machined Guide Rail	70mm*65mm*9mm	250*70*10mm	M12*35	T2
T70-1/A	Machined Guide Rail	70mm*65mm*9mm	250*70*10mm	M12*35	8K
T75-3B	Machined Guide Rail	75mm*62mm*10mm	240*75*10mm	M12*35	8K
T78/B	Machined Guide Rail	78mm*56mm*10mm	240*75*10mm	M12*35	8K
T82/B	Machined Guide Rail	82.5mm*68.25mm*9mm	216*80*10mm	M12*35	13K
T82-3/B	Machined Guide Rail	82mm*62mm*16mm	216*80*10mm	M12*35	13K
T89-1/B	Machined Guide Rail	89mm*62mm*16mm	305*90*13mm	M12*35	13K
T89/B	Machined Guide Rail	89mm*62mm*16mm	305*90*13mm	M12*35	13K
T90/B	Machined Guide Rail	90mm*75mm*16mm	305*90*13mm	M12*35	13K
T114/B	Machined Guide Rail	114mm*89mm*16mm	305*130*17mm	M16*45	18K
T127-1/B	Machined Guide Rail	127mm*89mm*16mm	305*130*17mm	M16*46	24K
T127-2/B	Machined Guide Rail	127mm*89mm*16mm	305*130*17mm	M16*47	24K
T140-1/B	Machined Guide Rail	140mm*108mm*19mm	380*140*25mm	M20*65	30K

• Fish Plate Technical Parameters

Type	D	D1	B2	B3	L1	L2	L3	H	Wxx	Wyy	Weight	Bolt
	mm	mm	mm	mm	mm	mm	mm	mm	cm²	cm²	kg/pcs	size
Tolerances			±1.5	±0.2	±1.5	±0.2	±0.2	±0.1				
RP75	13	26	75	43	240	90	30	61	9.29	7.06	2.1	M12X35
RP78	13	26	78	43	240	90	30	55	7.56	6.71	1.8	M12X36
RP82	13	26	82.5	50.8	216	81	27	66.6	10.2	7.4	1.36	M12X37
RP89	13	26	89	57.2	305	114.3	38.1	61	14.25	11.8	3.8	M12X38
RP90	13	26	90	57.2	305	114.3	38.1	74	20.85	11.8	4.1	M12X39
RP114	17	33	114	79.4	305	114.3	38.1	88	29.7	19.1	5	M16X45
RP125	17	33	125	79.4	305	114.3	38.1	81	26.2	25.4	5.5	M16X45
RP127-1	17	33	127	79.4	305	114.3	38.1	88	30.4	23.4	5.4	M16X45
RP127-2	17	33	127	79.4	305	114.3	38.1	88	30.9	36.2	6.9	M16X45
RP127-2 c14	17	33	127	79.4	305	114.3	38.1	88	31.06	36.25	7	M16X45
RP140-1	21	40	140	92.1	308	152.4	31.8	107	53.4	44.3	10.5	M20X65
RP140-2	21	40	140	92.1	308	152.4	31.8	101	68	51.2	12.9	M20X65
RP140-3	21	40	140	92.1	308	152.4	31.8	126	114.6	69.4	17.5	M20X65



▶ COP/LOP 090 INOX XEN GƯƠNG TRẮNG

• Technical Parameters

Surface Material: Hairline Or Mirrow
 Istallation: With box, Side Opening
 Connection Lop Cascade Multipce
 Button: Any Button



• Installation Dimension (mm)

Landing	A	Landing (Emergency Lighting)
2 ~ 14	1090	2 ~ 12
15 ~ 22	1270	13 ~ 20

▶ COP/LOP 090 INOX XEN GƯƠNG VÀNG

• Technical Parameters

Surface Material: Glass
 Istallation: Hanger



• Installation Dimension (mm)

Landing	A	Landing (Emergency Lighting)
2 ~ 14	1300	2 ~ 12

▶ COP 281 INOX SỌC NHUYỄN TRẮNG/ VÀNG

• Technical Parameters

Surface Material: Hairline Or Mirrow
 Istallation: With box, Side Opening
 Connection Lop Cascade Multipce
 Button: Any Button

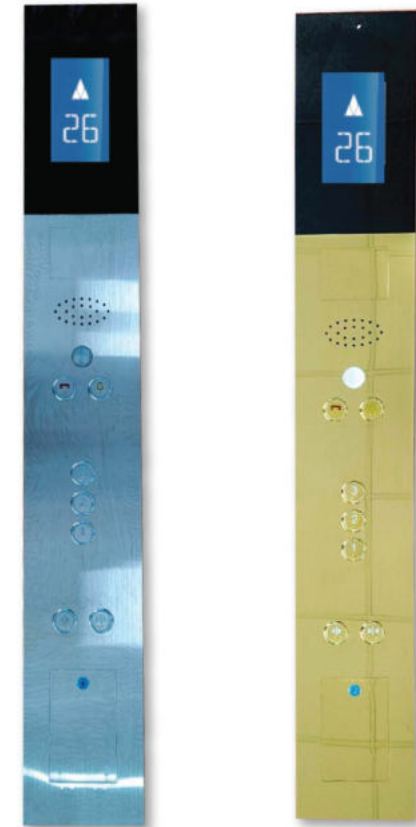

• Installation Dimension (mm)

Landing	A	Landing (Emergency Lighting)
2 ~ 14	1220	2 ~ 12



▶COP/LOP VTB8

• Technical Parameters

Surface Material: Glass
 Installation: With box, Side Opening
 Connection: Lop Cascade Multipce
 Button: Any Button



• Installation Dimension (mm)

Landing	A	Landing (Emergency Lighting)
2 ~ 14	80	2 ~ 12

▶COP/LOP CẢM ỨNG

• Technical Parameters

Surface Material: Glass
 Installation: Hanger



• Installation Dimension (mm)

Landing	A	Landing (Emergency Lighting)
2 ~ 14	1300	2 ~ 12

▶NÚT ẤN



● HPB-01

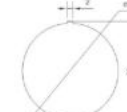

● HPB-20



● HPB-02

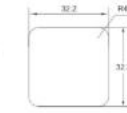

● HPB-21

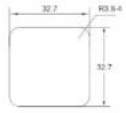

● HPB-11A

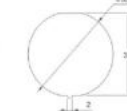

● HPB-10

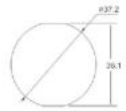

● HPB-12

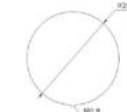

● HPB-34

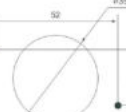



►SOURCE: 8 - 30V/ 1024JRE

 <p>C4A6 2.5LSB2/1024-JRE</p>	 <p>C4A82.5LSB2/1024-JRE</p>	 <p>EN-F3J6-2.5LSB2/1024-JRE</p>
 <p>EN-F3J8-2.5LSB2/1024-JRE</p>	 <p>HEIDENHAIN ERN1387/2048</p>	 <p>EL-B1A30-7LNB1/1024-JRE</p>
 <p>HEIDENHAIN ERN1313/2048</p>	 <p>EN-B1A35-7NB1/1024-JRE</p>	 <p>EN-A1A40-7NB1/1024-JRE</p>

 <p>HS3-1370 switch (NC/NO)</p>	 <p>JK2038 level switch</p>	 <p>WECO K3 level switch</p>
 <p>Sensor 61N KCB-R-59121</p>	 <p>Sensor 77NS KCB-R-59122</p>	 <p>Pitch Inspection Box</p>
 <p>Cross flow fan 25W/35W</p>	 <p>Arrival gong</p>	 <p>Arrival gong</p>
 <p>Oil can</p>	 <p>Oil Collector</p>	 <p>Intercom</p>

		
Panasonic inverter	Monarch inverter	UPS Apollo 2kVA
		
ECHUx0.75mm + 2x2Px0.75mm	Spring	Oil buffer
		
Door lock	Guide Rail Width 10,16mm	Guide Rail Width 10,16mm (hollow Track)
		
Bistable switch Module	Φ48/Φ56/Φ72 Pulley	Motor YVP90-6

Công ty chúng tôi xin cam kết:

- Sản phẩm của công ty Vitech bán ra đều là hàng chính hãng, được thu mua trực tiếp từ nhà máy sản xuất, nếu phát hiện hàng giả, chúng tôi bồi thường gấp 10 lần cho quý khách.
- Vitech chỉ cung cấp linh phụ kiện thang máy, không cung cấp nguyên thang.
- Tiêu chí của công ty Vitech là chỉ cung cấp sản phẩm chất lượng cho thị trường Việt Nam, đảm bảo chất lượng sản phẩm tuyệt đối.
- Vitech đồng hành cùng quý khách hàng, cùng nhau chứng kiến sự phát triển của thị trường thang máy Việt Nam.

"Bạn cần sản phẩm tốt, chúng tôi cho bạn giá tốt nhất"
"Bạn cần giá tốt, chúng tôi cho bạn sản phẩm tốt nhất"